

Panel Jacks — Standard and Miniature

Bezel Mount Standard Jack

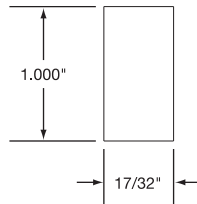

ANSI Calibration	Body Color	Part Number
J	Black	TCA-102-137
K	Yellow	TCA-102-138
T	Blue	TCA-102-139
E	Purple	TCA-102-140
R/S	Green	TCA-102-141
U*	White	TCA-102-142
N	Orange	TCA-102-180

Miniature 2-Pin Panel Jack

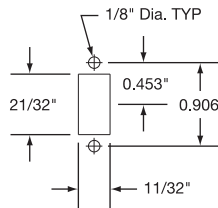

ANSI Calibration	Body Color	Part Number
J	Black	TCA-102-143
K	Yellow	TCA-102-144
T	Blue	TCA-102-145
E	Purple	TCA-102-146
R/S	Green	TCA-102-147
U*	White	TCA-102-148

Standard 3-Pin Panel Jack

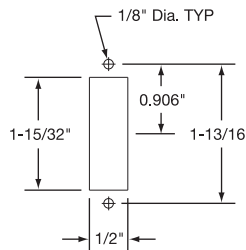

ANSI Calibration	Body Color	Part Number
J	Black	TCA-102-149
K	Yellow	TCA-102-150
T	Blue	TCA-102-151
E	Purple	TCA-102-152
R/S	Green	TCA-102-153
U*	White	TCA-102-154

Miniature 3-Pin Panel Jack

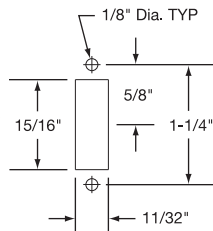

ANSI Calibration	Body Color	Part Number
J	Black	TCA-102-155
K	Yellow	TCA-102-156
T	Blue	TCA-102-157
E	Purple	TCA-102-158
R/S	Green	TCA-102-159
U*	White	TCA-102-160

Panel Mount Standard Jab-In Jack

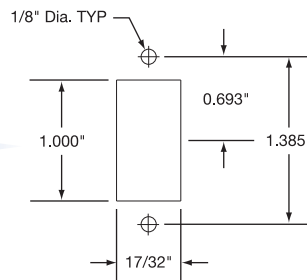
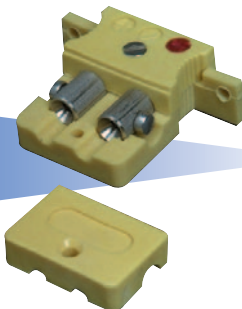

ANSI Calibration	Body Color	Part Number
J	Black	TCA-102-161
K	Yellow	TCA-102-162
T	Blue	TCA-102-163
E	Purple	TCA-102-164
R/S	Green	TCA-102-165
U*	White	TCA-102-166



Note: All panel jacks have the same high quality features as their non-panel counterparts and include hardware for mounting.

* "U" is designated for RTDs and type B thermocouples

Panel Jacks are rated for 350°F (177°C) continuous and 400°F (204°C) intermittent.