

### Non-contact Infrared Temperature Measurement System — NCIT-LC Plus Series

#### Measurement Specifications

<b>Temperature Range:</b>	-40 to 1112°F (-40 to 600°C)
<b>Spectral Response:</b>	8 to 14 μm
<b>Optical Resolution:</b>	10:1
<b>System Accuracy:</b>	±1% or ±1°C, whichever is greater
<b>Repeatability:</b>	±0.5% or ±0.5°C, whichever is greater
<b>Response Time:</b>	150 ms, 95% of final reading
<b>Emissivity:</b>	Digitally adjustable, 0.1 to 1.10 by increments of 0.001 steps
<b>Signal Processing:</b>	Peak hold, Valley hold, Variable averaging filter, adjustable up to 998 sec.



**Note:**  
The basic system includes the sensing head and nut, die cast housing with pre-mounted electronic board, 3m (10 ft.) cable, and operator manual.

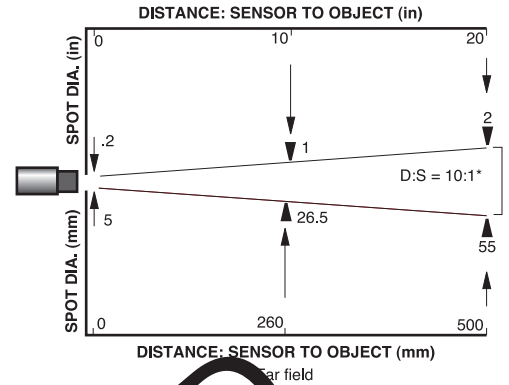

#### Electrical Specifications

**Programmable Outputs:** 0/4 - 20 mA, 0 - 5 Vdc (scalable)  
J or K thermocouple  
10 mV / °C head ambient signal

**Power (user to supply unit):** 12 - 24 Vdc @ 100 mA  
**Max. Loop Impedance:** 500Ω with 24 Vdc power supply

#### Sensor Specifications

**Environmental Rating:** NEMA 4 (IP65)  
**Max. Ambient Temperature:** Sensing head: 32° to 185°F (0 to 85°C)  
With air cooling up to 392°F (200°C)  
Elect. housing: 32° to 149°F (0 to 65°C)  
**Relative Humidity:** 10 to 95%, non-condensing  
**Weight:** Sensing head: 50g w/cable, stainless steel  
Electronics housing: 270g, Zinc, die-cast

#### Model Numbers

Part Number	Optical Resolution	Cable Length	Range Type
REN00150	10 : 1	10 ft. / 3 m	LT - low temp
REN00155	10 : 1	3 ft. / 1 m	LT - low temp
REN00170	22 : 1	10 ft. / 3 m	LT - low temp
REN00175	22 : 1	3 ft. / 1 m	LT - low temp
<b>with RS485 data interface</b>			
REN00151	10 : 1	10 ft. / 3 m	LT - low temp
REN00156	10 : 1	3 ft. / 1 m	LT - low temp
REN00171	22 : 1	10 ft. / 3 m	LT - low temp
REN00176	22 : 1	3 ft. / 1 m	LT - low temp

**Communication Accessory Connection Kits** are required for setup and monitoring of extended multi-drop features. One kit can service multiple sensors. These kits contain DataTemp® Multi-Drop software and connectors to provide for simple setup of analog/digital inputs and outputs of the optional RS232 or RS485 interface via a PC.

- REN00306** — RS485 2-wire connection kit provides for setup and monitoring via DataTemp® Multi-Drop software and a RS485/RS232 converter provided with 110Vac power supply
- REN00307** — RS232 connection kit provides for setup and monitoring via DataTemp® Multi-Drop software and a 3-wire RS232 connection
- REN00209** — Power supply: 12 Vdc at 200 mA, 120 Vac input

#### Sensor Head

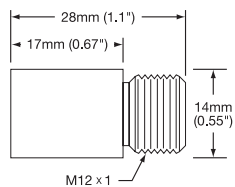

$$\text{Dim.} = \frac{\text{mm}}{(\text{in})}$$

#### Electronics Enclosure

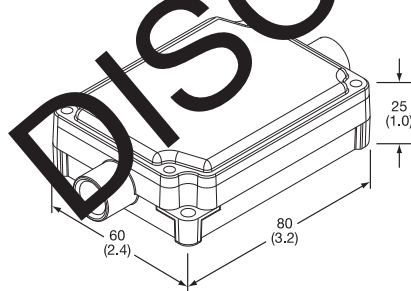

Optional: Electronics enclosure with view port window in cover  
**Part Number: REN00308**

#### Adjustable Mounting Bracket — REN00303

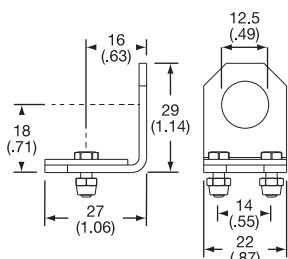

#### Optical Lens Air Purging Jacket — REN00302

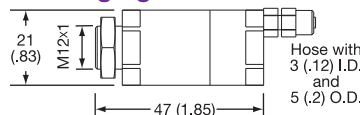

#### Air Cooling System — REN00301

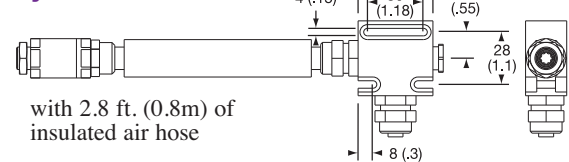

#### Ordering Information

Choose the **NCIT-LC Plus**, accessories, and/or options desired, and order by the associated part number.

**Standard lead time is stock to 3 weeks.**