

Quartz Single and Triple-Tube Style Heaters

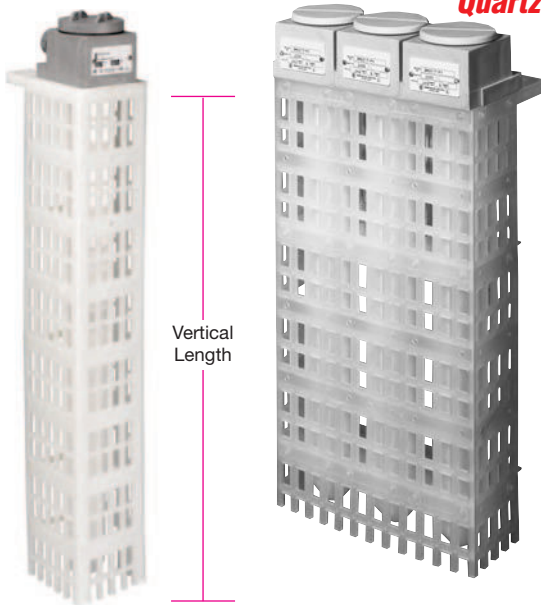

Design Features

- * 26 watts/in² (4.0 watts/cm²) for long service life
- * Heavy duty, long lasting construction
- * T1 thermal fuse protection standard; T2 bi-metal switch optional
- * Replaceable element and quartz tube
- * Grounded for safety
- * UL listed up to 4 KW/assembly for US and Canada
- * Vapor-tight polypropylene terminal enclosure with universal mounting bracket
- * Standard 3-ft. flexible PVC liquid-tight conduit
- * Standard guards are made of polypropylene. Fluoropolymer (PTFE) guards are available for chromic acid and temperatures above 180°F (82°C).
- * KMH1 Single-Phase standard; three-phase available as an option
- * KMH3 consists of three individual single-phase heaters, which can be wired delta in the field to achieve a three-phase balanced operating system; individual elements are field replaceable
- * 120, 240, 480 volts standard as listed—other voltages available
- * Longer lengths available; consult Tempco

Typical Applications

For plating tanks, pickling and other acidic aqueous solutions. Check compatibility guide on pages 11-88 and 11-89 and with chemical supplier for proper sheath material selection.



Not for use in hydrofluoric acid or alkaline solutions.

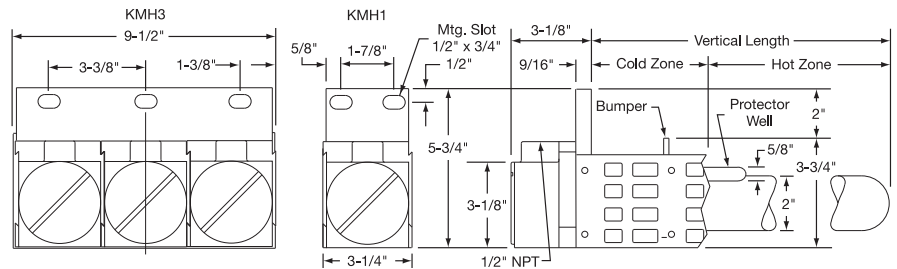

Ordering Code: K M H

Type: KMH1 or KMH3

Length (in.) → _____

Hot Zone (in.) → _____

Watts ÷ 100 → _____

Phase: 1 or 3

Voltage
1 – 120
2 – 240
4 – 480

Thermal Over-Temperature Protection

Thermal Fuse	Bi-Metal Switch
1L – Solutions up to 180°F	2L – Solutions up to 180°F
1M – Solutions from 180°F to 220°F	2M – Solutions from 180°F to 220°F

Conduit Length (in.)
36" standard

Style
C – Complete Assembly
H – Less Guard
E – Element Only
J – Tube Only

Standard Watts vs. Length and Hot Zone

KMH1 Watts	KMH3 Watts	Hot Zone in	Hot Zone mm	Length in	Length mm
500	1500	6	152	10	254
1000	3000	7	178	11	279
1000	3000	7	178	17	432
2000	6000	12	305	17	432
2000	6000	12	305	23	584
3000	9000	18	457	23	584
3000	9000	18	457	29	737
3500	11500	21	533	29	737
4000	12000	28	711	35	889
4000	12000	28	711	41	1041
5000	15000	33	838	41	1041
5000	15000	33	838	47	1194
6000	18000	39	991	47	1194
6000	18000	39	991	52	1321
8000	24000	49	1245	59	1499
10000	30000	62	1575	71	1803

Standard lead time is 2 to 3 weeks.

Ordering Information

KMH1 and KMH1 heaters are offered with the options listed in this worksheet. Create an ordering code by filling in the blanks with the appropriate number and/or letter designation for your requirements, and a part number will be assigned.

WARNING: Cancer and Reproductive Harm - www.P65Warnings.ca.gov.