

### 4, 6 & 8 CONDUCTORS

#### 4 Conductors, 30 Amp, High Voltage

#### Model 435

Part No.	Conductors	Description	VOLTAGE AC/DC	AMP RATING AT 500 VAC	MAX FREQ. MHz	CONTACT RESISTANCE	MAX OP. RPM	TEMPERATURE Max.F(C) / Min.F(C)	ROTATION Torque (gm-cm)	CIRCUIT SEPARATION
MER00435	4	High Voltage Model	0-500	30	100	<1mΩ	300	140(60)/-20(-29)	850	>50MΩ
MER00436	4	High Voltage Stainless Steel Bearing	0-500	30	100	<1mΩ	300	140(60)/-20(-29)	850	>50MΩ

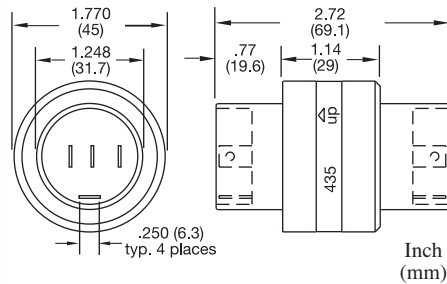

Includes (4) MER90009 and (4) MER90010

#### ACCESSORIES



**MER90009**  
Terminal 16-14 AWG



**MER90010**  
Terminal 16-14 AWG



**MER90103**  
Boot Kit  
For dust and splash protection  
IP51

Terminals for other wire gauges available.

#### 6 Conductors, Combination 4 Amp & 30 Amp

#### Model 630

Part No.	Conductors	Description	VOLTAGE AC/DC	AMP RATING AT 240 VAC	MAX FREQ. MHz	CONTACT RESISTANCE	MAX OP. RPM	TEMPERATURE Max.F(C) / Min.F(C)	ROTATION Torque (gm-cm)	CIRCUIT SEPARATION
MER00630	6	Standard Model	0-250	2@4/4@30	100	<1mΩ	300	140(60)/-20(-29)	700	>25MΩ
MER00631	6	Stainless Steel Bearing	0-250	2@4/4@30	100	<1mΩ	300	140(60)/-20(-29)	700	>25MΩ

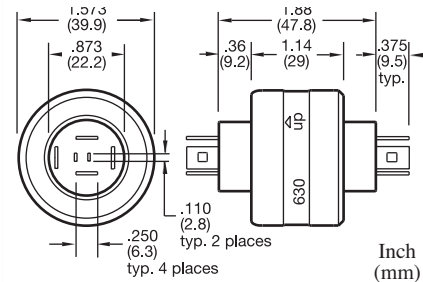

Includes (4) MER90008, (4) MER90010, (4) MER90019 and (4) MER90021

#### ACCESSORIES



**MER90008**  
Terminal 22-18 AWG



**MER90021**  
Shrink Tube



**MER90019**  
Terminal 16-14 AWG



**MER90010**  
Terminal 16-14 AWG



**MER90104**  
Boot Kit  
For dust and splash protection  
IP51

Terminals for other wire gauges available.

#### 8 Conductors, Combination 4 Amp & 30 Amp

#### Model 830

Part No.	Conductors	Description	VOLTAGE AC/DC	AMP RATING AT 240 VAC	MAX FREQ. MHz	CONTACT RESISTANCE	MAX OP. RPM	TEMPERATURE Max.F(C) / Min.F(C)	ROTATION Torque (gm-cm)	CIRCUIT SEPARATION
MER00830	8	Standard Model	0-250	2@4/6@30	100	<1mΩ	200	140(60)/-20(-29)	1000	>25MΩ
MER00831	8	Stainless Steel Bearing	0-250	2@4/6@30	100	<1mΩ	200	140(60)/-20(-29)	1000	>25MΩ

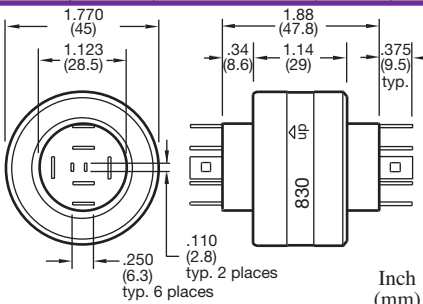

Includes (4) MER90008, (6) MER90010, (6) MER90019 and (6) MER90021

#### ACCESSORIES



**MER90008**  
Terminal 22-18 AWG



**MER90021**  
Shrink Tube



**MER90019**  
Terminal 16-14 AWG



**MER90010**  
Terminal 16-14 AWG



**MER90105**  
Boot Kit  
For dust and splash protection  
IP51

Terminals for other wire gauges available.