

### Cooling Tube Termination Options for Liquid-Cooled Cast-In Band Heaters

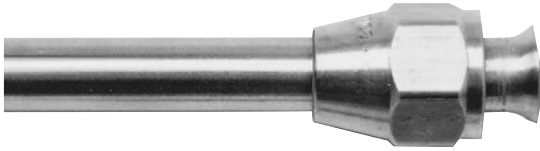

#### Type FF Flared Seal Fittings

Brass flared seal fittings are well adapted for low to medium pressure and resistant to mechanical pullout. Available for 3/8" and 1/2" diameter tubing with SAE 45° flare.

Diameter Tubing	Thread	Part Number
3/8"	5/8"-18	FTG-124-101
1/2"	3/4"-16	FTG-124-104

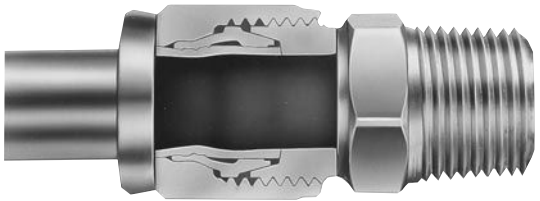

#### Type HS Hi-Seal Fittings

Hi-seal brass fittings are highly dependable under the most adverse conditions. For reliable and trouble-free service with ease of installation, we strongly recommend hi-seal fittings. Available for 3/8" and 1/2" diameter tubing. Male thread is 1/2" NPT for 1/2" tube and 3/8" tube.

Diameter Tubing	Part Number
3/8"	FTG-118-124
1/2"	FTG-118-116



#### Type RA 90° Copper Elbow

90° copper elbow is brazed to the Cast-In Heater cooling tube extension with additional tube extension for connecting cooling lines with compression and/or flared fittings. Available for 3/8" and 1/2" diameter tubing. If required, specify.

Diameter Tubing	Part Number
3/8"	FTG-127-102
1/2"	FTG-127-103



#### Type RT Cast Brass 90° Threaded Elbow

90° threaded elbow is brazed to the cooling tube extension, providing an easy and quick method for connecting cooling lines. Recommended to be factory installed to assure good braze seals. Available for 3/8" and 1/2" NPT internal threads. If required, specify.

Diameter Tubing	NPT	Part Number
1/2"	3/8"	FTG-125-101
1/2"	1/2"	FTG-125-102



#### Type R3 Straight Threaded Copper Fitting

Straight threaded fitting is brazed to the cooling tube extensions, providing an easy and quick method for connecting cooling lines. Recommended to be factory installed to assure good braze seals. Available for 3/8" and 1/2" diameter tubing with internal threads. If required, specify.

Diameter Tubing	NPT	Part Number
3/8"	3/8"	FTG-131-103
1/2"	3/8"	FTG-131-102
1/2"	1/2"	FTG-131-101